

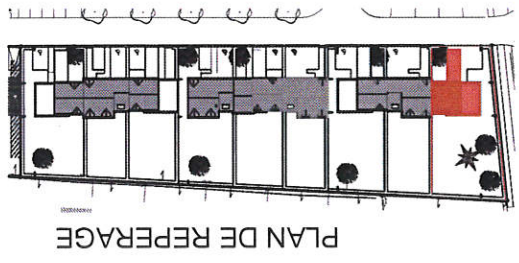

9 MAISONS INDIVIDUELLES
 Route d'Aunay sur Odon - 14930 ETERVILLE
 5 JANVIER 2022



A01
 ETAGE 1
 T4

Séjour/cuisine	31.11m ²
Dgt	2.44m ²
SDD	5.90m ²
WC.	2.48m ²
Pl	1.48m ²
Chambre 1	12.36m ²
Chambre 2	10.05m ²
Chambre 3	10.09m ²
SDD	4.28m ²
Palier	2.62m ²
SURF. HAB.	82.81m ²
Jardin	322.53m ²
Cellier	3.96m ²

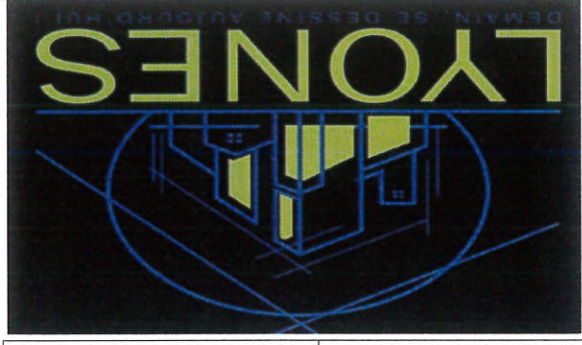

0 1 5

